

82 MD

FENÊTRES ET PORTES

7
chambres

3
joints

1.0*
 U_f

0.84*
 U_w



 **Veka 82 MD**



 **Veka 82 MD Portes**



 **Classe A**
Norme PN-EN 12608:2004

* U_f et U_w pour les fenêtres. Pour la porte $U_f = 1,2$, $U_w = 1,3$

** Valeur U_w avec bords chauds. Ces valeurs servent de référence et sont données pour une fenêtre de dimensions 1230 x 1480 mm.

SPÉCIFICATIONS TECHNIQUES

VEKA 82



Dormants

Ouvrants

Meneaux / traverses

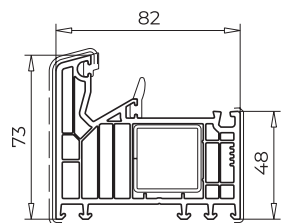

101.290

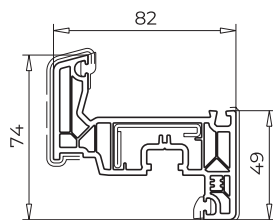

103.340

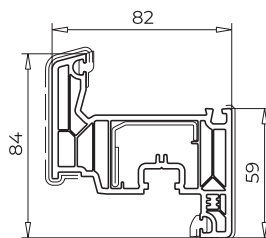

103.341

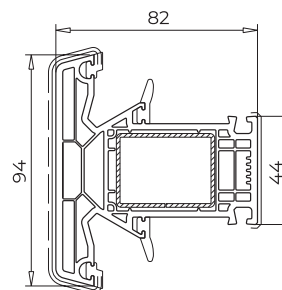

102.310

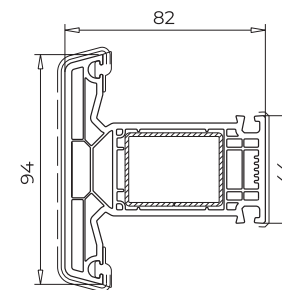

102.312

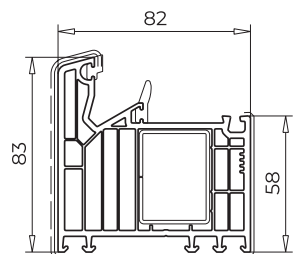

101.291

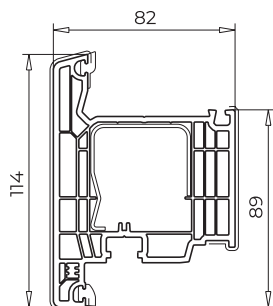

103.346

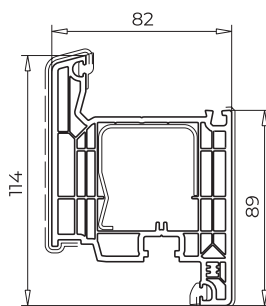

103.345

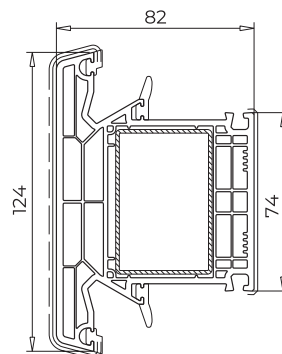

102.311

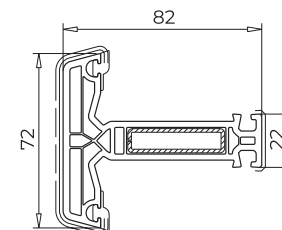

102.315

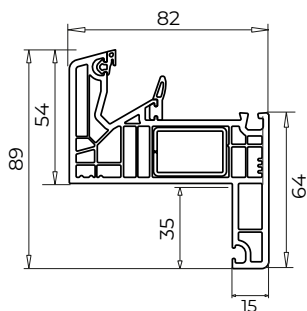

101.300

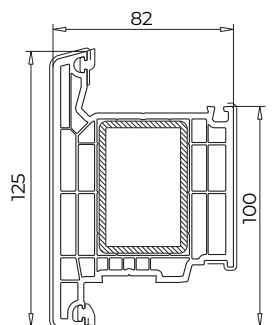

105.381

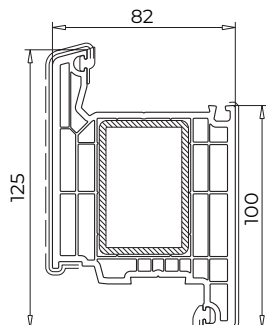

105.380

Meneaux mobiles

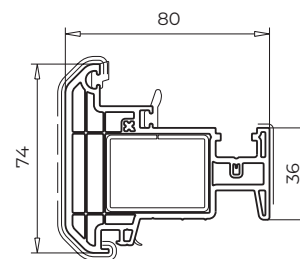

102.316

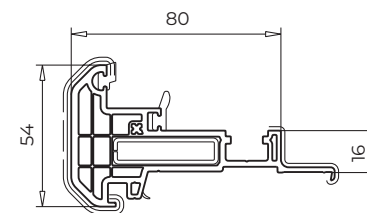

102.314

SPÉCIFICATIONS TECHNIQUES



VEKA 82

Élargisseurs

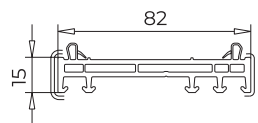

114.040

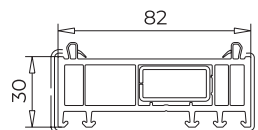

114.041

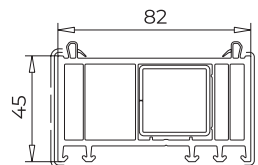

114.042

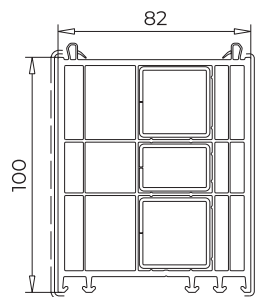

114.043

Profils de jonction

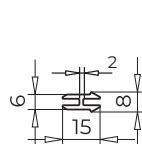

116.030

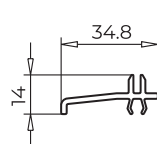

116.053

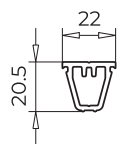

116.213

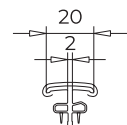

116.217

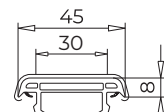

116.210

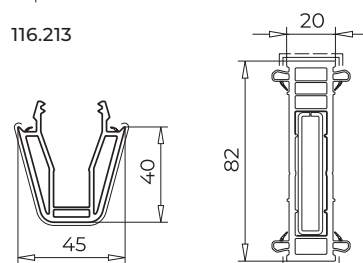

116.211

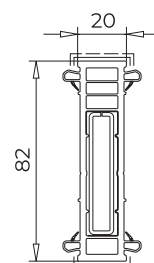

116.219

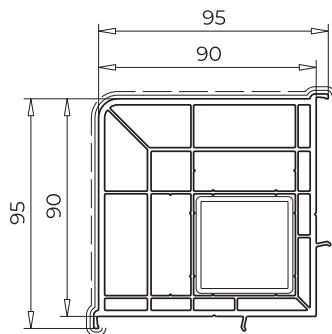

116.214

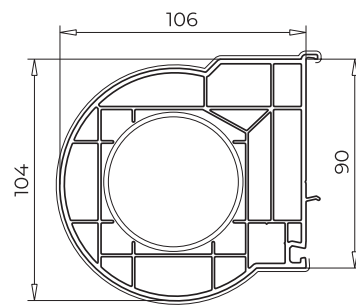

116.216

Pièces d'appui

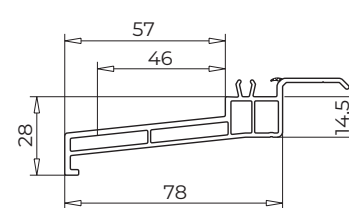

110.078

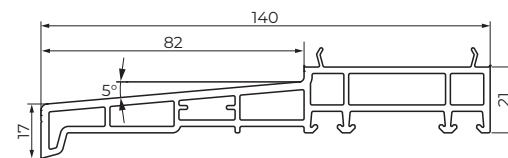

110.080

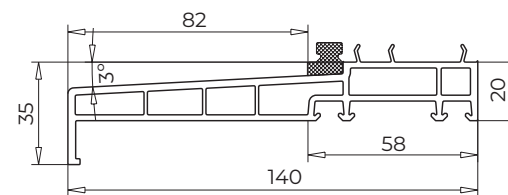

110.105

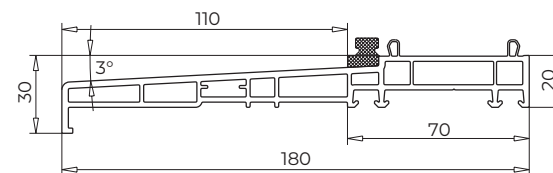

110.112