

76 MD

FENÊTRES ET PORTES

5
chambres

3
joints

1.1*
 U_f

0.87*
 U_w



 **Veka** 76 MD



 **Veka** 76 MD Portes



 **Classe A**
Norme PN-EN 12608.2004

* U_f et U_w pour les fenêtres. Pour la porte $U_w = 1,3$, $U_f = 1,3$

** Valeur U_w avec bords chauds. Ces valeurs servent de référence et sont données pour une fenêtre de dimensions 1230 x 1480 mm.

SPÉCIFICATIONS TECHNIQUES

VEKA 76 MD



Dormants

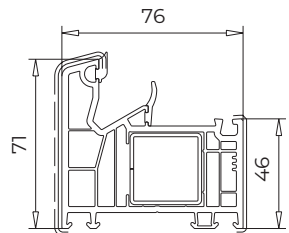

101.350

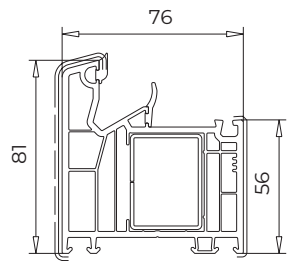

101.351

Ouvrants

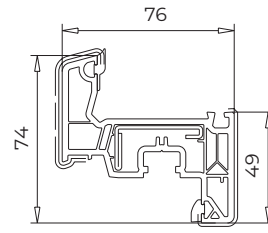

103.380

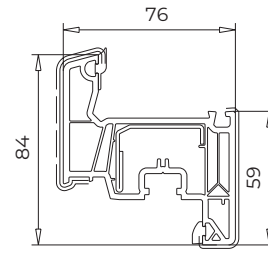

103.381

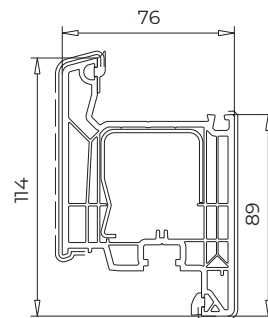

103.385

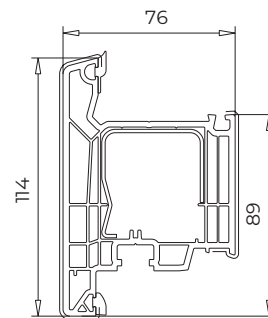

103.386

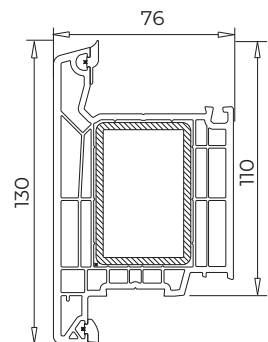

105.400

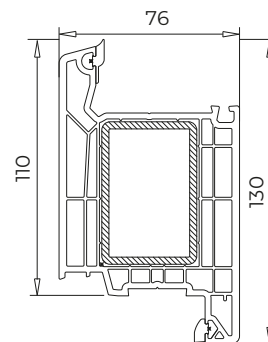

105.401

Meneaux / traverses

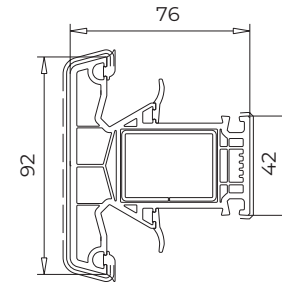

102.350

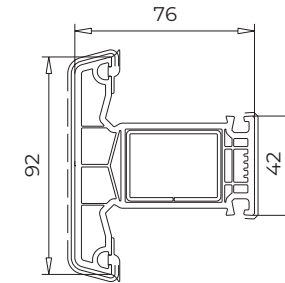

102.352

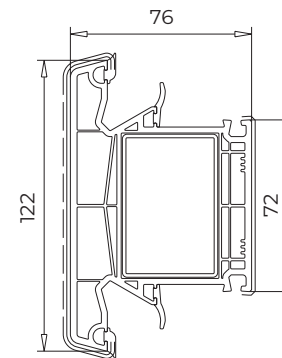

102.351

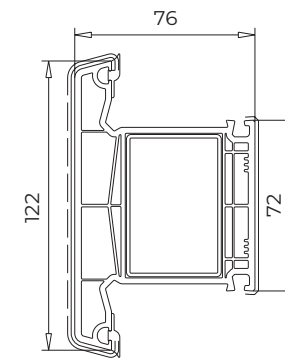

102.357

Meneaux mobiles

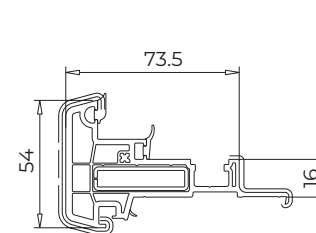

102.354

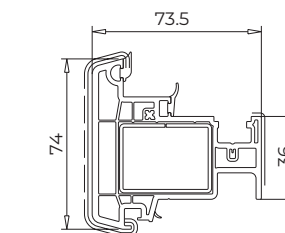

102.356

SPÉCIFICATIONS TECHNIQUES



VEKA 76 MD

Élargisseurs

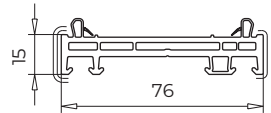

114.052

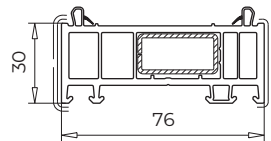

114.053

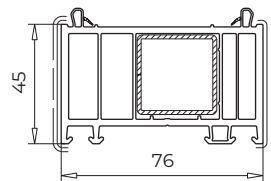

114.054

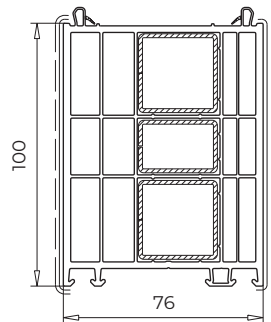

114.055

Profils de jonction

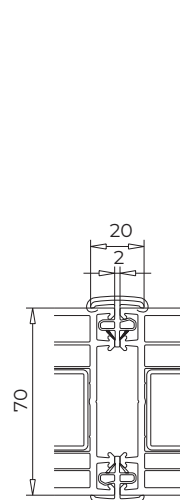

116.217

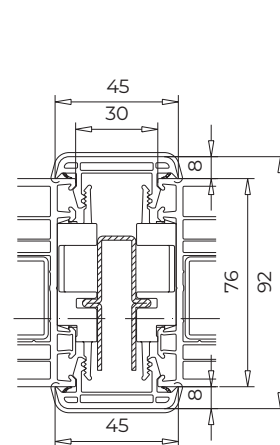

116.210 + 116.210

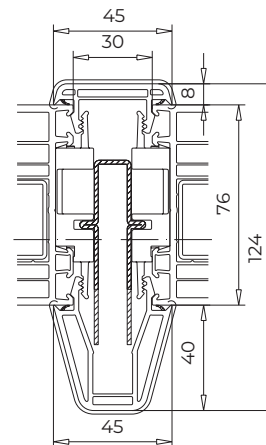

116.211 + 116.210

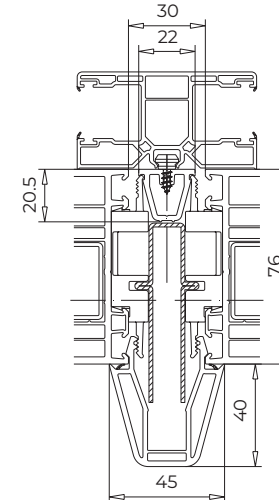

116.211 + 116.213

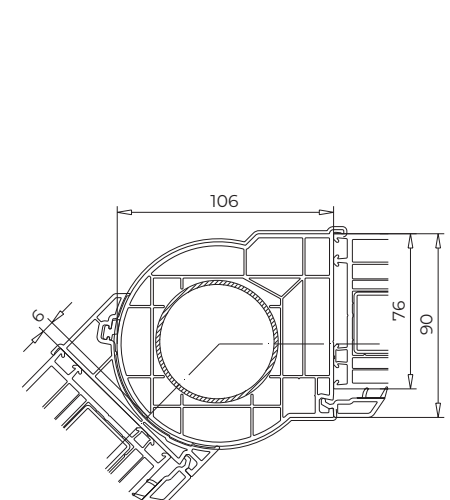

116.216.2

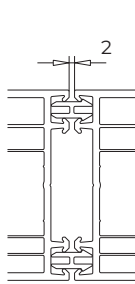

116.030

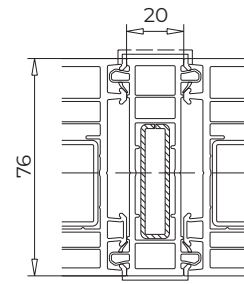

116.230

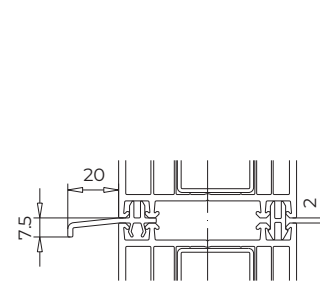

116.053

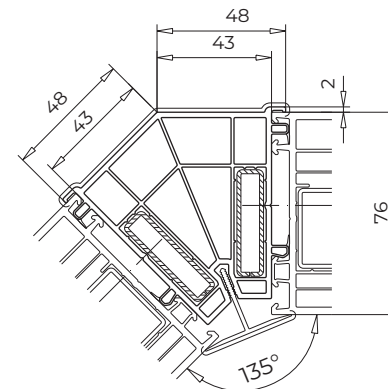

116.226

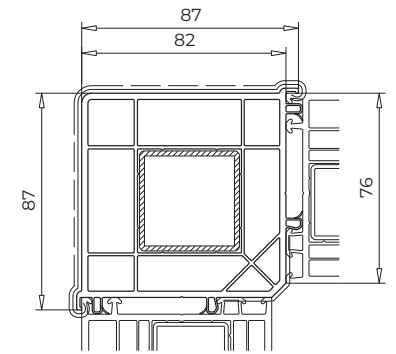

116.229