

# 70 AD

## FENÊTRES ET PORTES

5  
chambres

2  
joints

1.3  
 $U_f$

1.3\*  
 $U_w$



 **Veka 70 AD**



 **Veka 70 AD Portes**



**PERFECTCORNER**



**Classe A**

Norme PN-EN 12608:2004

\*  $U_f$  pour les fenêtres. Pour la porte  $U_f = 1,8$

\*\* Valeur  $U_w$  avec bords chauds. Ces valeurs servent de référence et sont données pour une fenêtre de dimensions 1230 x 1480 mm.

# SPÉCIFICATIONS TECHNIQUES

VEKA 70



## Dormants

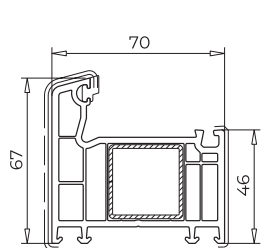

101.208

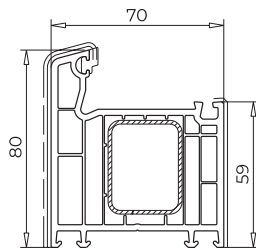

101.214

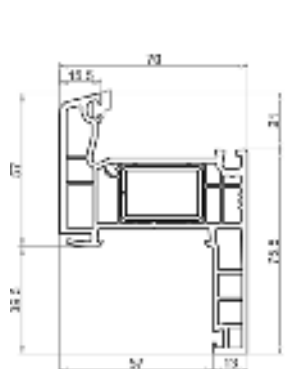

111.053

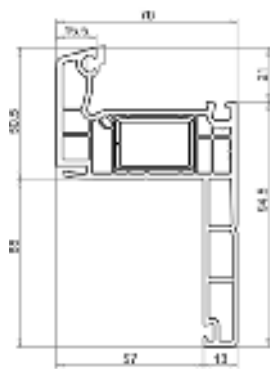

111.045

## Pièce d'appui

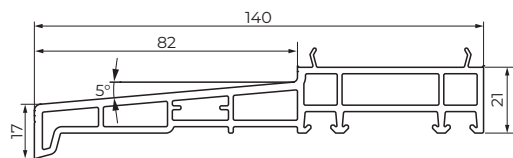

110.080

## Ouvrants

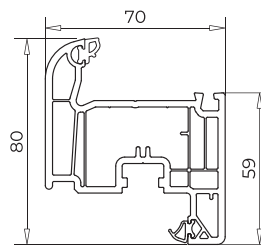

103.232

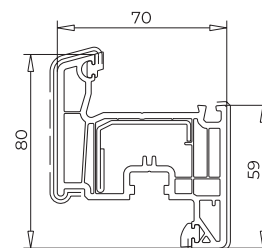

103.235

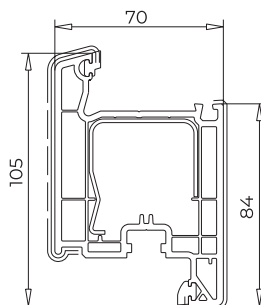

103.241

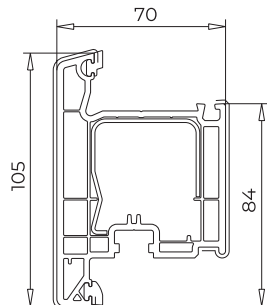

103.242

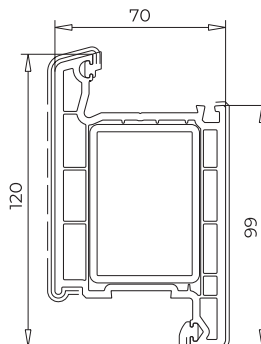

105.232

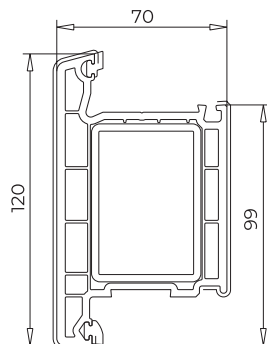

105.233

## Meneaux / traverses

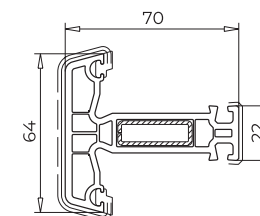

102.237

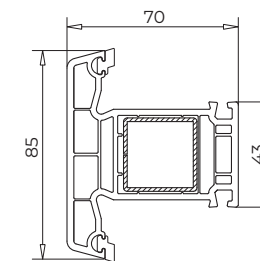

102.214

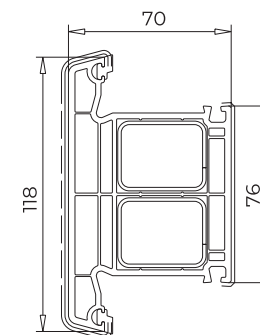

102.238

## Meneaux mobiles

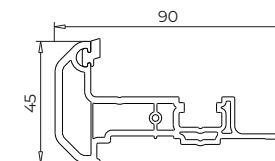

102.219

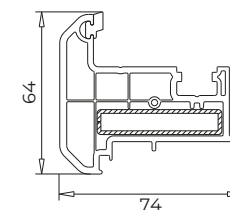

102.236

# SPÉCIFICATIONS TECHNIQUES



## VEKA 70

### Masses centrales

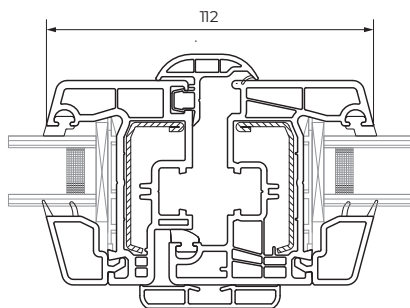
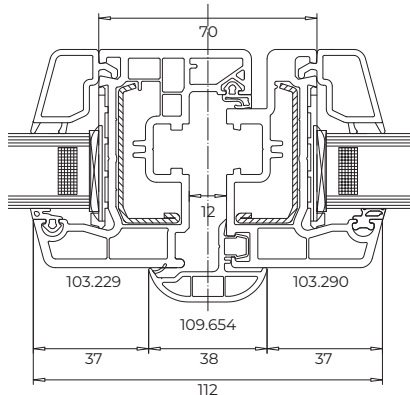

103.229

### Élargisseurs

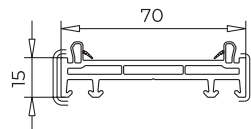

114.200

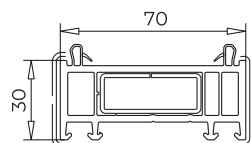

114.201

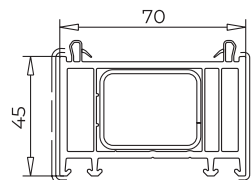

114.202

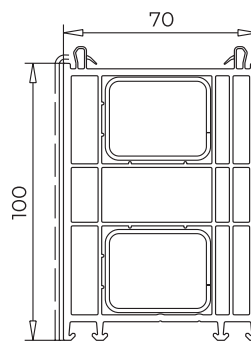

114.203

### Profils de jonction

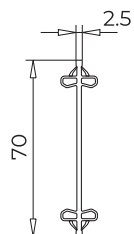

116.019

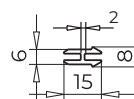

116.030

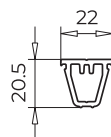

116.213

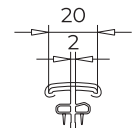

116.217

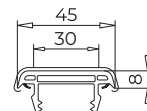

116.210

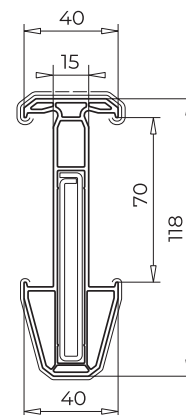

116.207

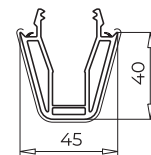

116.211

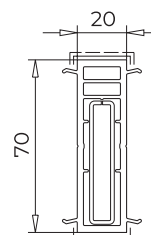

116.201

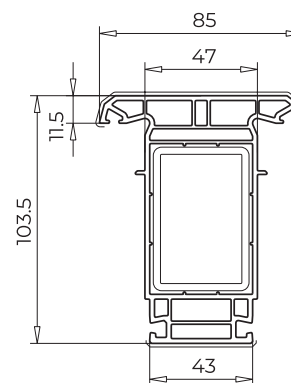

116.202

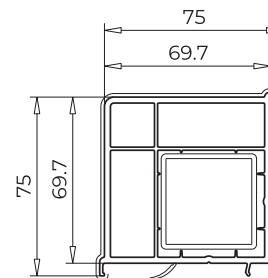

116.218

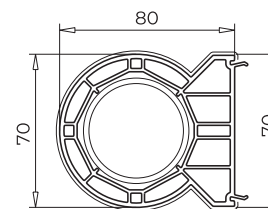

116.206

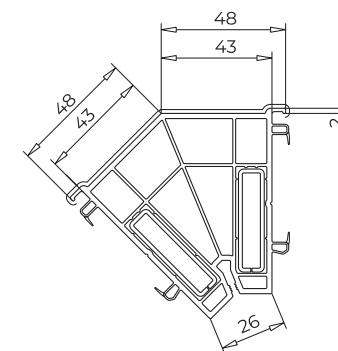

116.226

### Seuils aluminium

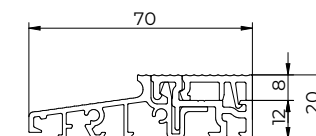

TS57032

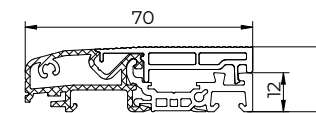

104.427